

ACTUATOR FEATURES

- Visual Position Indicator (removable for mounting NAMUR Accessory)
- Actuator Body : Hard Anodized Aluminum Alloy
- End Caps : Powder Coated Die Cast Aluminum
- Two Independent External Travel Stop Adjustment Bolts (+ or - 5deg)
- 1/4" NPT Air Supply Connections with NAMUR drilling to suit NAMUR Solenoid Accessory

VALVE FEATURES

- Full Port, 1/2" - 3" (DN100)
- W.P. : 1000 WOG (PN63)
- W.T. : -4°F to 392°F (-20°C to 200°C)
- Investment Casting
- Blow-Out Proof Stem
- Live-Loaded Design
- ISO 5211 Direct Mounting Pad
- Length Conforms to DIN 3202-4
- Thread Type : ASME B1.20.1 (NPT)

OPTIONS

LIMIT SWITCH

- Mechanical Switch 120VAC (NEMA 4, 4X)
- Inductive Proximity 24VDC (IP 67)

CONTACT US FOR ADDITIONAL LIMIT SWITCH OPTIONS

SOLENOID

- NAMUR Solenoid 120VAC/24VDC (NEMA 4, 4X)
- NAMUR Solenoid 120VAC/24VDC (NEMA 7)

CONTACT US FOR ADDITIONAL SOLENOID OPTIONS

PARTS & DIMENSIONS

ACTUATOR

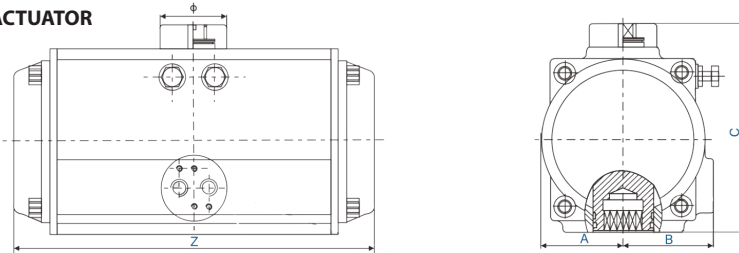

VALVE

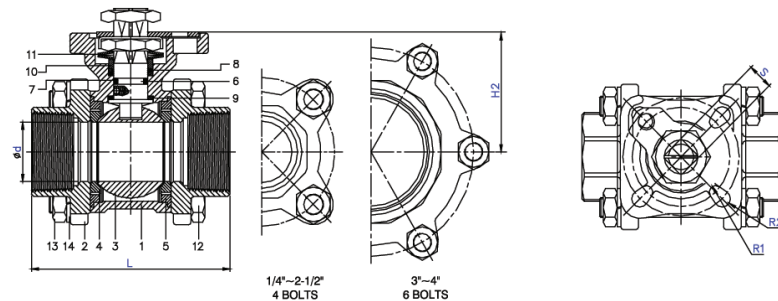

| ITEM | PARTS | MATERIAL |
|------|-------------------|----------------|
| 1 | BODY | ASTM A351-CF8M |
| 2 | CAP | ASTM A351-CF8M |
| 3 | BALL | ASTM A351-CF8M |
| 4 | SEAT | PTFE / RTFE |
| 5 | SEAL | PTFE |
| 6 | STEM | ASTM A276-316 |
| 7 | O-RING | VITON |
| 8 | PACKING | PTFE |
| 9 | THRUST WASHER | |
| 10 | GLAND RING | AISI 304 |
| 11 | BELLEVILLE WASHER | AISI 301 |
| 12 | BOLT | AISI 304 |
| 13 | NUT | |
| 14 | SPRING WASHER | |

| NPT | ACTUATOR DIMENSIONS | | | | ISO 5211 | VALVE DIMENSIONS | | | | | | Valve Torque | Actuator Torque | Assembly Weight | Part # |
|--------|---------------------|-------|-------|-------|----------|------------------|-------|-------|-------|-------|-------|--------------|-----------------|-----------------|-------------------|
| | Z | A | B | C | | d | L | H2 | S | R1 | R2 | | | | |
| 1/2" | 5.79" | 1.18" | 1.63" | 3.62" | F03/F04 | 0.59" | 2.56" | 1.43" | 0.35" | 0.11" | 0.11" | 62 in-lb | 194 in-lb | 4.5 lb | CBV052013ND/52DA |
| 3/4" | 5.79" | 1.18" | 1.63" | 3.62" | F03/F04 | 0.79" | 2.95" | 1.56" | 0.35" | 0.11" | 0.11" | 79 in-lb | 194 in-lb | 4.9 lb | CBV072013ND//52DA |
| 1" | 5.79" | 1.18" | 1.63" | 3.62" | F04/F05 | 0.98" | 3.35" | 1.93" | 0.43" | 0.11" | 0.14" | 132 in-lb | 194 in-lb | 5.7 lb | CBV102013ND/52DA |
| 1-1/4" | 6.69" | 1.48" | 1.81" | 4.29" | F04/F05 | 1.26" | 3.98" | 2.13" | 0.43" | 0.11" | 0.14" | 159 in-lb | 354 in-lb | 8.6 lb | CBV132013ND/65DA |
| 1-1/2" | 6.69" | 1.48" | 1.81" | 4.29" | F05/F07 | 1.5" | 4.41" | 2.54" | 0.55" | 0.14" | 0.18" | 221 in-lb | 354 in-lb | 10.7 lb | CBV152013ND/65DA |
| 2" | 7.24" | 1.65" | 2.09" | 4.72" | F05/F07 | 1.97" | 5.12" | 2.85" | 0.55" | 0.14" | 0.18" | 309 in-lb | 488 in-lb | 14.9 lb | CBV202013ND/75DA |
| 2-1/2" | 8.11" | 1.81" | 2.24" | 5.06" | F07/F10 | 2.48" | 6.38" | 3.62" | 0.67" | 0.18" | 0.22" | 486 in-lb | 762 in-lb | 23.7 lb | CBV252013ND/85DA |
| 3" | 10.31" | 1.97" | 2.30" | 5.37" | F07/F10 | 2.99" | 7.4" | 3.94" | 0.67" | 0.18" | 0.22" | 619 in-lb | 1098 in-lb | 34.3 lb | CBV302013ND/92DA |

Pre-Configured Valve Assemblies are based on minimum 80 psi Instrument Air Pressure