

CC SERIES



Tuthill's CC Series of close coupled pumps offer compactness and economy.

With lots of pump performance in a relatively small space, the CC Series is ideal for package pumping skids or applications where space is limited. By eliminating the need for adapters, reducers, couplings, bases and guards, the CC Series also saves on first cost and eliminates the need for maintenance of these components down the road.

Pump Sizes and Flow Ranges	009 – 6.1 to 9.2 GPM 015 – 10.8 to 16.2 GPM 020 – 14.4 to 21.8 GPM 030 – 21.4 to 32 GPM
-----------------------------------	--

Application Range	Viscosity to 10,000 SSU Pressure to 100 PSI Temperature • 200° F for Buna seal • 375° F for Viton seal
--------------------------	---

Standard Features	Single Buna mechanical seal Opposite NPT threaded ports Direct mount to NEMA C-face or IEC motors Carbon idler bushing
--------------------------	---

Optional Features	Single Viton mechanical seal Internal relief valve or return to tank valve BSP or SAE ports
--------------------------	---

Available Features	Jacketed cover Greased idler pin Tungsten carbide idler bushing Tungsten carbide idler pins
---------------------------	--

Highlights

Close coupled design
Cast iron construction

Typical Applications

Lube oil
Fuel oil
Glycol solutions (Anti-freeze)
Water treatment polymers
Machine tool coolants
Filtering waste oil

Competitive Advantages

Includes Carbon Bushing as Standard
Ductile Iron Rotor and Idler for Strength – CC curves go to 10,000 ssu

Eliminates Need for

Bases
Gear Reducers
Adapters
Couplings
Coupling Guards



Engineered Solutions

12500 South Pulaski Road
Alsip, Illinois 60803 USA
phone: 708-389-2500
fax: 708-388-0869
email: tuthillpump@tuthill.com
www.tuthillpump.com

CC SERIES PUMP

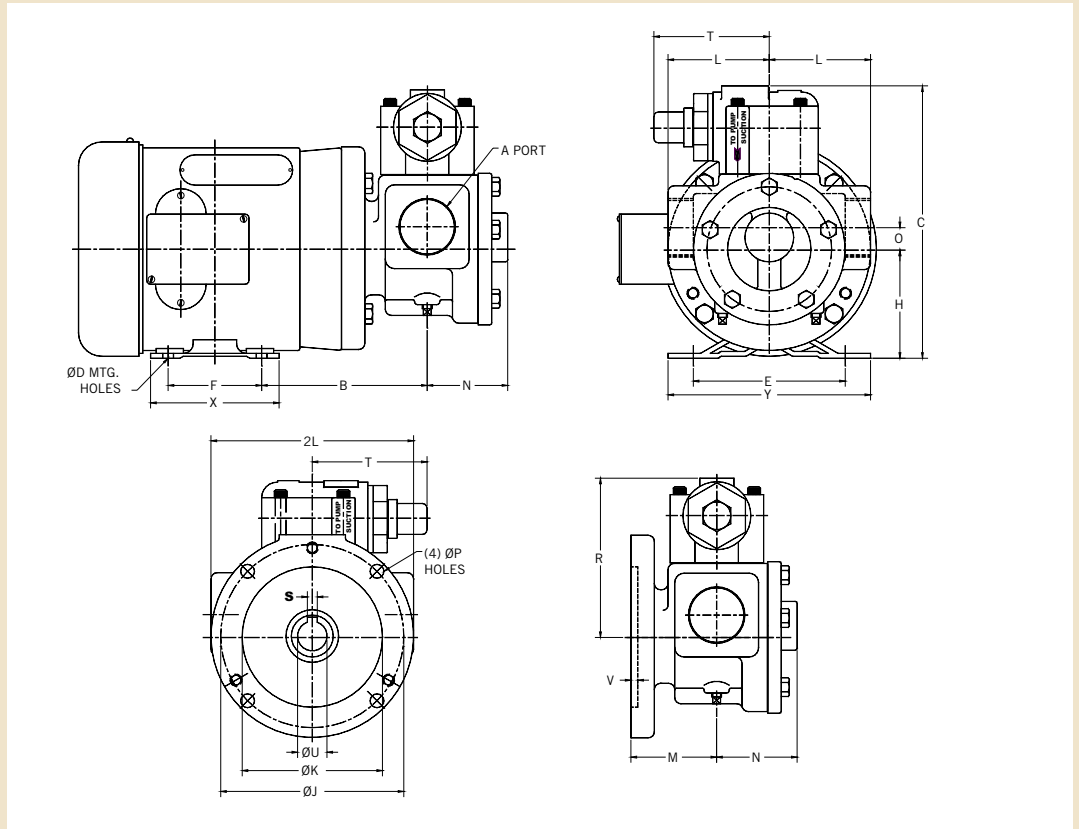

CC09 Pump/Motor Mounting Dimensions (Inches)

Motor Frame Size	A	B	C	D	E	F	H	J	K	L	M	N	O
56C	1" NPT	5 25/64	8 5/16	11/32	4 7/8	3	3 1/2	5 7/8	4 1/2	2 1/2	2 53/64	1 31/64	17/32
143TC	or	5 5/64	8 5/16	11/32	5 1/2	4	3 1/2	5 7/8	4 1/2	2 1/2	2 53/64	1 31/64	17/32
145TC	1" BSP	5 5/64	8 5/16	11/32	5 1/2	5	3 1/2	5 7/8	4 1/2	2 1/2	2 53/64	1 31/64	17/32

Motor Frame Size	P	R	S	T	U	V	X	Y
56C	15/32	4 13/16	3/16	3 23/32	5/8	15/64	3 3/4	6 3/16
143TC	15/32	4 13/16	3/16	3 23/32	7/8	15/64	5	6 7/8
145TC	15/32	4 13/16	3/16	3 23/32	7/8	15/64	5	6 7/8

CC015, 020 & 030 Pump/Motor Mounting Dimensions (Inches)

Motor Frame Size	A	B	C	D	E	F	H	J	K	L	M	N
56C	1 1/2" NPT or 1 1/2" BSP	5 23/64	8 49/64	11/32	4 7/8	3	3 1/2	5 7/8	4 1/2	3 1/4	2 47/64	2 23/32
143TC		5	8 49/64	11/32	5 1/2	4	3 1/2	5 7/8	4 1/2	3 1/4	2 47/64	2 23/32
145TC		5	8 49/64	11/32	5 1/2	5	3 1/2	5 7/8	4 1/2	3 1/4	2 47/64	2 23/32
182TC*		5 23/64	9 49/64	1/2	7 1/2	5 1/2	4 1/2	5 7/8	4 1/2	3 1/4	2 47/64	2 23/32
184TC*		5 23/64	9 49/64	1/2	7 1/2	5 1/2	4 1/2	5 7/8	4 1/2	3 1/4	2 47/64	2 23/32

Motor Frame Size	O	P	R	S	T	U	V	X	Y
56C	5/8	15/32	4 3/8	3/16	3 45/64	5/8	15/64	3 3/4	6 3/16
143TC	5/8	15/32	5 17/64	3/16	3 45/64	7/8	15/64	5	6 7/8
145TC	5/8	15/32	5 17/64	3/16	3 45/64	7/8	15/64	6	6 7/8
182TC*	5/8	15/32	5 17/64	3/16	3 45/64	7/8	15/64	6 23/32	9
184TC*	5/8	15/32	5 17/64	3/16	3 45/64	7/8	15/64	6 23/32	9

Note frame size when making motor selection. *Will require a special "C" motor flange and a 7/8" shaft.



TUTHILL
Pump Group

Engineered Solutions

12500 South Pulaski Road
Alsip, Illinois 60803 USA
phone: 708-389-2500
fax: 708-388-0869
email: tuthillpump@tuthill.com
www.tuthillpump.com