

Shown with Nozzle Clearance Spheres

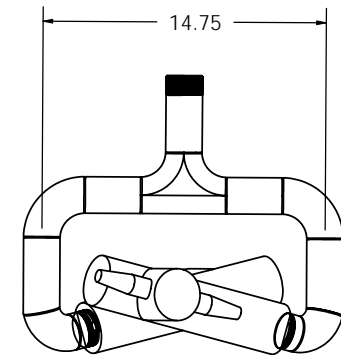

VIEW A

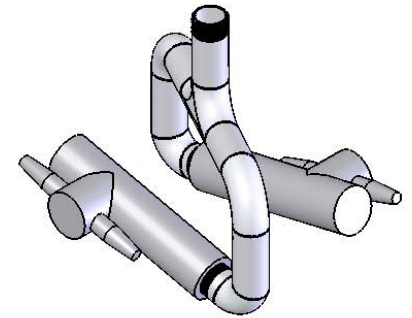
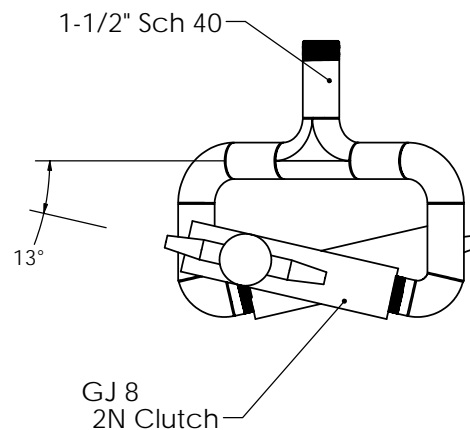
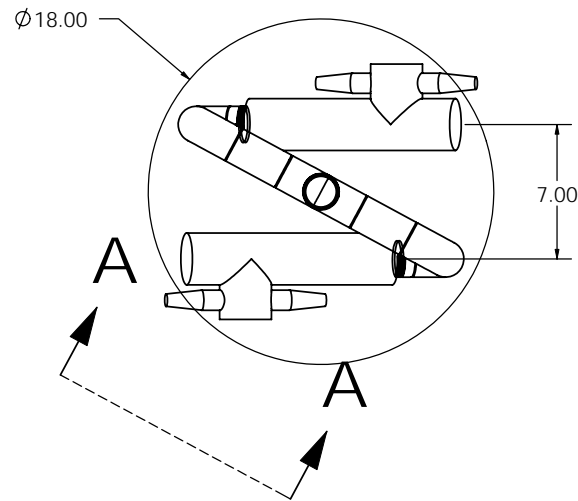
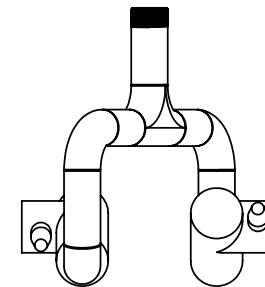

Note:
Clearance is approx. 1/2" on each side of $\phi 18"$, and between nozzle clearance spheres.

THIS DRAWING IS THE PROPERTY OF ALFA LAVAL. REPRODUCTIONS AND USE OTHER THAN BORROWER'S AGREEMENT IS PROHIBITED. THIS DOCUMENT SHALL NOT BE LENT OR DISPOSED OF DIRECTLY OR INDIRECTLY NOR USED FOR ANY PURPOSE OTHER THAN THAT WHICH IS SPECIFICALLY FURNISHED.

DRAWN	DATE	Rev.	Description
BFG	04/11/06	1	New Drawing

UNLESS OTHERWISE SPECIFIED * DIMENSIONS ARE IN INCHES * ALL WELDS TO BE TIG * GRIND SMOOTH AND SAND * NO BURRS, NO SHARP EDGES * FILLET RAD.: 0.015 * TOLERANCES: XX ±1/8" ANGLE ±3°		Alfa Laval	
MATERIAL: 304 SS		6	
FINISH (UNLESS OTHERWISE SPECIFIED): 125 Ra		TITLE Tanker Cross Concept Drawing	
SCALE: Full		EQUIPMENT GJ 8	
		DWG. NO. ---	SHEET 1 OF 1